



kien<sup>®</sup>

# Manual

kien BUNDLE (or multiple SATs)

December 2021

© kien 2021. All rights reserved



# Table of contents

<b>Let's start</b>	<b>3</b>
Intro	3
Explanation of controls and light	4
Link a SAT to a streaming device Link the other	6
SAT(s) to the first (leader) SAT Stream music	7
Reconnect	8
	9
<b>Stereo sound</b>	<b>10</b>
<b>Settings</b>	<b>11</b>
General	11
Volume	11
<b>Usage scenarios</b>	<b>12</b>
Remove SAT from the SAT group	12
Create a second SAT group	12
<b>Firmware update</b>	<b>13</b>
<b>Specifications</b>	<b>14</b>
<b>Important safety information</b>	<b>15</b>



# Let's start

## Intro

*Congratulations on purchasing your kien SATs!  
In this part of the guide we will walk you through the process of installing your SATs.*

*We first explain where the buttons and status light are located and what they are for. We will then help you connect your phone, tablet, laptop or other streaming device to one of the SATs.*

*Then we'll show you how to create an SAT group by linking the SATs together. Within the group we consider the SAT, which is connected to your streaming device via Bluetooth, as the 'leader' of the group. We call the other SAT(s) 'follower(s)'.*

*We also explain how to play your favorite music, how to reconnect the SAT group to the streaming device when the connection is lost and what you need to do to restore the mutual connection between the SATs within the SAT group.  
Note: The charger and the correct plug-in plug for each SAT can be found at the bottom of the styrofoam.*

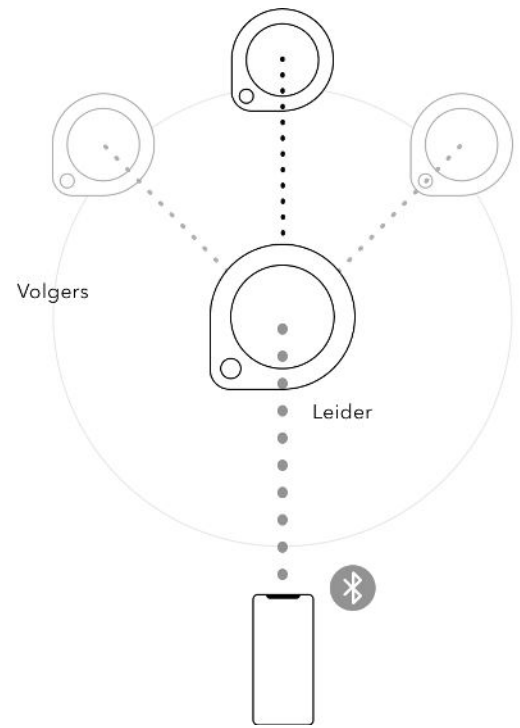



## Explanation of controls and light

We start with an explanation of where all the buttons are, what they are for and what the different colors of light mean.



### 1. Touch ring

The touch ring only becomes active when the SAT is placed on its side with the bump in the corner and the dots on the ring facing up. This prevents unwanted control commands from being activated when the SAT is being carried around. The audio playback controls are as follows:

- Swipe your finger clockwise to increase volume
- Swipe your finger counterclockwise to decrease the volume
- Tap once briefly to pause/play a song
- Tap twice in succession to skip to the next song
- Tap briefly three times in succession to skip to a previous song

### On/off button

If the SAT is off:

- Press once to turn on the SAT

If the SAT is on:

- Press once to put the SAT in standby mode

When the SAT is in standby mode:

- Press once to wake the SAT from standby mode
- Press and hold to turn off the SAT

Since the SAT is not completely off in standby mode, the SAT starts up faster from standby than when it is completely off. This has an effect on the battery level when the SAT is not connected to the power. For more information about standby mode, see chapter 'Reconnecting' (page 9).

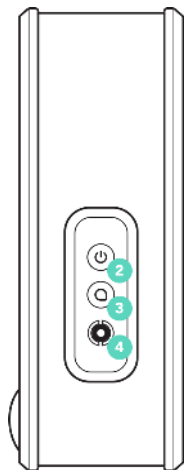

### 3. Connect button

With the connect button you switch between two modes: the 'Bluetooth Connect mode' and the 'Speaker Connect mode'. In the 'Bluetooth Connect mode' you can connect the SAT to your streaming device and in the 'Speaker Connect mode' you can connect the SAT to another small speaker.

- Connect knop eenmaal indrukken om te schakelen tussen deze twee standen. De SAT zoekt automatisch naar een eerder gekoppeld apparaat of speaker en probeert te verbinden.
- Connect knop ingedrukt houden om in één van de twee standen te kunnen koppelen.

### 4. Power cable input & Status light

The status light, around the power cable entrance, shows different colors. This indicates the status of the SAT. Below we describe what each color of light means and the difference between fast flashing, slow pulsating, constant and dimmed light:



### White - Initialization

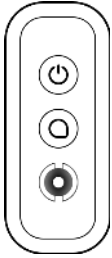

Fast flashing white light:  
The SAT thinks. This happens when the SAT is turned on and when switching to another mode

### Blue - 'Bluetooth Connect': SAT is trying to connect to a streaming device

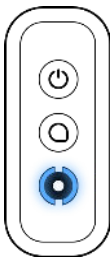

Fast flashing blue light:  
The SAT is looking for a previously connected streaming device

Slow pulsating blue light:  
The SAT is ready to pair with a streaming device

Constant blue light:  
The SAT is connected to a streaming device

Dimmed blue light:  
The SAT is on standby

### Pink - 'Speaker Connect': SAT is trying to connect to another smart speaker

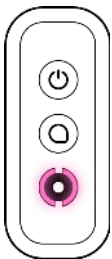

Fast flashing pink light:  
The SAT is looking for a previously connected Kien speaker

Slowly pulsating pink light:  
The SAT is ready to connect with another smart speaker

Dimmed pink light:  
The SAT is on standby

### Blue-Pink - 'Speaker Connect': SAT is connected to another SAT

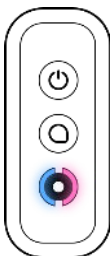

Constant blue-pink light:  
The SAT is connected to another SAT



### Green/Yellow/Red light: Battery level

Green: Full battery

Yellow: Medium full battery

Red: Empty battery. Load up on the SAT as soon as possible.

The battery level is displayed shortly after initialization of the SAT and when the charging cable is plugged in. The battery level is also visible in the Kien app.

## Connect a SAT to a streaming device

*Note: If you want to charge the SATs, you can find the chargers and the correct plug-in plugs at the bottom of the styrofoam.*

1. Before you start installing the SAT, download the kien app and turn on Bluetooth on your streaming device (phone, tablet, laptop, etc.).
2. Briefly press the on/off button once to turn on the SAT. As it initializes, the status light will flash rapidly in white and then briefly display the battery level in green, yellow, or red.
3. After initializing, the status light will automatically start flashing blue. Wait until you hear a signal. This means that the SAT has finished initializing. If the status light flashes pink, press the connect button once. The status light should now flash blue.

*Please note: if the SAT is flashing yellow-white-blue or yellow-white-pink, turn off the SAT by pressing and holding the on/off button. Turn the SAT back on by pressing the on/off button once. Go through steps 2 and 3 again.*

4. Open the Kien app and indicate that you do not have a SUB, but an SAT. The next 4 steps are also described in the app.

5. Press and hold the connect button until you hear a signal. The status light will now slowly start to pulse blue. If the status light lights up pink i. p.v. blue, then wait for the signal, press the connect button again and go back to step 3.
6. Now that the status light is slowly pulsing blue, you can open your device's Bluetooth settings.

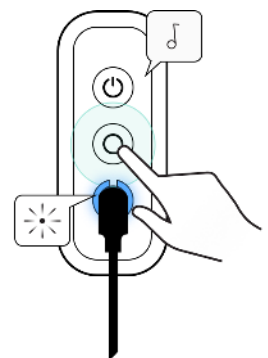
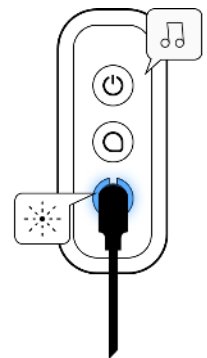
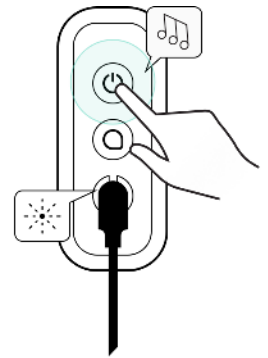



7. The SAT will appear in your Bluetooth list as a 'pairable device'.  
 Select the SAT to pair and connect. The status light shows a constant blue light when the SAT is paired.  
 Android users: select the connection with the headphones icon as shown below. This is the correct connection for media audio. If the pairing fails and it states that an app is required to connect to the device, you have selected the wrong (Bluetooth Low Energy) connection.

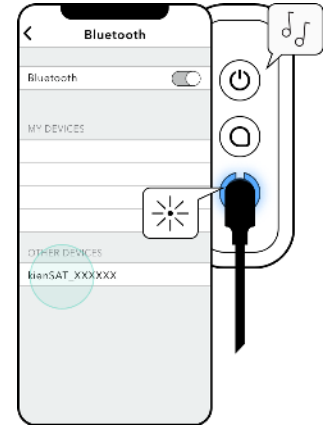

## Link the other SAT(s) to the first (leader) SAT

After you connect the streaming device to the first SAT, the SAT is ready to be used as a leader of a SAT group. To create the SAT group we will link the following SAT:

1. Briefly press the on/off button once to turn on the SAT. As it initializes, the status light will flash rapidly in white and then briefly display the battery level in green, yellow, or red. If not, the SAT may be defective. Please contact us.

2. After initializing, the status light will start flashing blue automatically. Wait until you hear a signal. This means that the SAT has finished initializing. If the status light flashes pink, proceed to step 5.

*Please note: if the SAT is flashing yellow-white-blue or yellow-white-pink, turn off the SAT by pressing and holding the on/off button. Turn the SAT back on by pressing the on/off button once. Go through steps 1 and 2 again.*

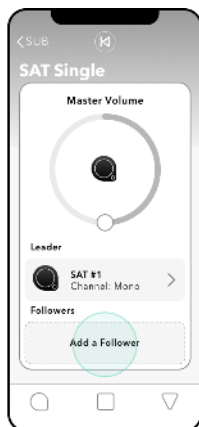

3. Open the Kien app and click on the 'Add Follower' button. The next steps are also described in the app.

4. Now briefly press the connect button. The status light will now start flashing pink quickly. As soon as you hear a signal, click on 'Next step: Enable pairing mode' in the app.

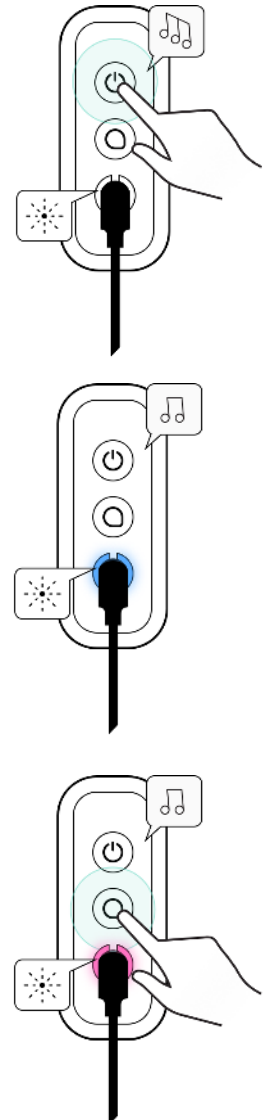



5. Press and hold the connect button until you hear a signal. The status light slowly begins to pulse pink. Then click on 'Next step: Connect SAT with SUB' in the app.

*Please note: you now have 60 seconds to complete step 6 in the app.*

*Please note: if the status light has turned blue again, wait for the signal and press the connect button again so that the light turns pink again and perform step 5 again.*

*Note: Even if a SAT is already paired and connected to a SUB (white-pink status light), you can connect the SAT to the Leader SAT by switching on the pairing mode (press and hold the connect button) and then performing step 5 again.*

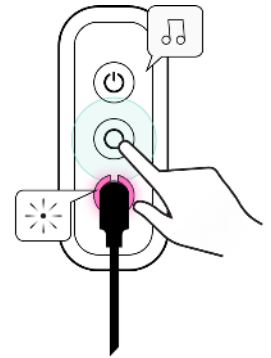

6. Press the 'Accept Follower' button in the app. Once the status light turns blue-pink, the follower SAT is connected to the leader SAT. In the app you will see the newly added SAT under the heading 'Followers'. Repeat steps 1 through 6 for each SAT you want to link to the Leader SAT.

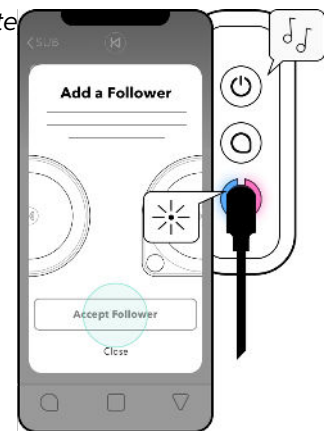

## Stream Music

Now that one of your SATs is connected to your streaming device and the other SAT(s) is/are connected to this leader SAT, you can play your favorite music or videos. Since there is a Bluetooth connection, all the sound from your device will be amplified by the SAT group. It therefore does not matter which app you use to play music or video material.







## Reconnect

As soon as you put the leader SAT in standby mode, turn it off or disconnect the Bluetooth connection on your streaming device, the sound from your streaming device will no longer be amplified by the SAT group and the group will no longer be visible in the Kien app .

*Note: an active leader SAT that receives no input for 15 minutes will automatically go into standby, regardless of whether it is powered or not.*

When the leader SAT is in standby mode or turned off, linked followers will lose their leader. These automatically start searching for their leader SAT and indicate this with a pink flashing status light. After 5 minutes of searching, followers will automatically go into standby. We therefore recommend that you only put the leader in standby mode or switch it off for a group, then followers will automatically go into standby. When you then turn the leader back on, the followers will automatically come out of standby mode, as described below.

Reconnecting with the leader SAT (and the SAT group) can be done in several ways  
a Depending on your situation:

- **When the leader SAT and follower(s) are disabled**

Press the power button on each SAT once to turn them all on. Reconnect your streaming device by selecting the leader SAT from the list of paired devices in your streaming device's Bluetooth settings. The follower SAT will automatically connect to the leader SAT. If this does not happen, open the Kien app, click on 'Add follower' on the SAT dashboard and click through to the screen where you click on 'Accept follower'. There is no need to reset the follower SAT to pairing mode.

- **When the leader SAT is off and the follower(s) are on standby mode**

Press the on/off button of the leader SAT once. Make again connect to your streaming device by selecting the leader SAT from the list of paired devices in your Bluetooth settings streaming device. At the same time, the leader will SAT, the follower SATs automatically wake up from standby mode and connect. If not happen, then open the Kien app, click on 'Add follower' on the SAT dashboard and click through to the screen where you click on 'Accept follower' There is no need to reset the follower SAT to pairing mode.



- **When the leader SAT and follower(s) are in standby mode**

Two different ways:

- Press the power button of the leader SAT once to take it out of standby. The leader will attempt to re-establish the connection to the previously paired streaming device. Therefore, make sure that Bluetooth is turned on on your device and the leader SAT will connect automatically. In addition, the leader SAT will automatically wake up the follower(s) from their standby mode and connect them.
- Select the leader SAT from the list of paired devices in the Bluetooth settings of your streaming device. The SAT will then automatically come out of standby mode, take the tracker(s) out of standby and connect to your device.

*Please note: if you manually put follower SATs into standby mode before you put leader SAT on standby or turn off, the follower SATs will not automatically come out of standby mode when the leader SAT is turned back on. . You will still have to manually take them out of standby by briefly pressing the on/off button once.*



- When the leader SAT is on but Bluetooth is off**  
 This scenario does not affect the connection between leader and follower(s). These simply remain connected when there is no Bluetooth connection between the leader and the streaming device.
- Turn on Bluetooth on your device. The leader will attempt to reconnect with your device. If the connection does not re-establish automatically, open your device's Bluetooth settings and select the SAT from the list of paired devices.

Once the Leader SAT is connected to your streaming device you will hear the connection signal and the status light will show a steady blue light. From that moment on, the leader SAT, and therefore the SAT group, is visible again in the app.

The same signal is given to the follower SAT, which in turn connects to its leader SAT. The status light shows a constant blue-pink light.

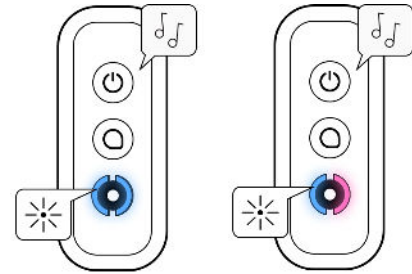

## Stereo sound

Once you have linked two or more SATs together, each SAT can be provided with a stereo channel. Follow these steps for each SAT:

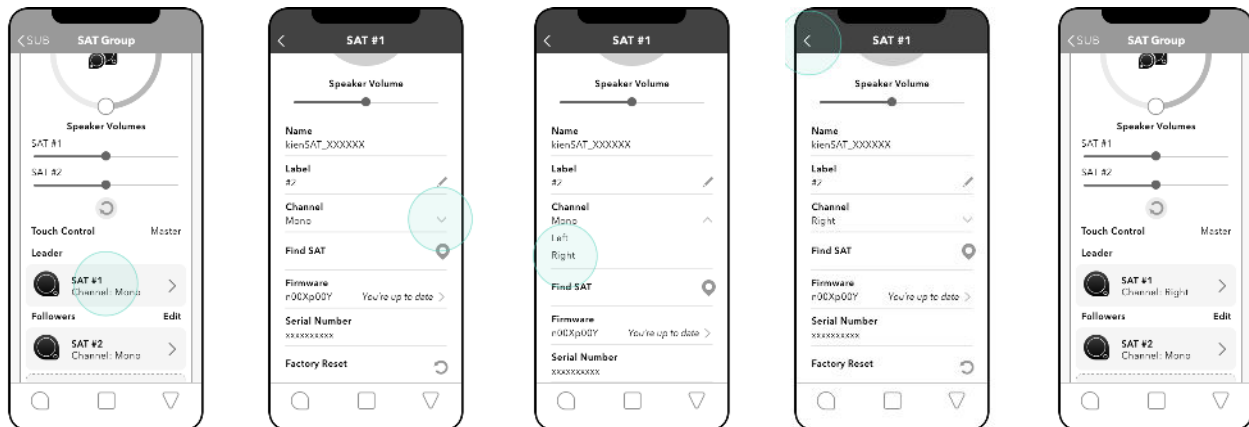

- Open the Kien app and click on the tile of an SAT within the SAT group.
- Scroll to the 'Channel' section and click on the arrow to see the available channels.
- Select the desired channel
- Return to the dashboard. Here the channel on the tile will have visibly changed.



# Settings

## General

In the Kien app you can view the general settings of each SAT by clicking on the corresponding tile. You will see the following sections here:

### **Name**

This is the hardware name that matches the name in the Bluetooth list of your streaming device.

### **Label**

The label shows a pre-filled number. Click on the number to change the label to your liking.

### **Channel**

Below you will see 'Mono'. That is the default channel of every SAT. If you have multiple SATs and possibly a SUB, you could choose stereo or surround channels here.

### **Find SAT**

Click here to have the DAT play a short signal to give you an indication of where the SAT is.

### **Touch Ring Sensitivity**

With the touch ring sensitivity control, the sensitivity of the ring can be changed to low, medium, high or maximum sensitivity. The default is medium. The ring can also be turned off.

### **Firmware**

Under Firmware you can see which firmware version the SAT currently has. We make improvements to our products every day, which means that a firmware update is available every now and then. These will be visible on the app dashboard and can be updated under this heading when you click on this section. See chapter 'Firmware update' (page 13) for the necessary instructions.

### **Serial number**

If you use our support, we may ask you for this serial number.

### **Factory settings**

With the factory settings, the Bluetooth settings are reset and the SAT restarts. After resetting the SAT to factory settings you will need to reconnect it to your streaming device if it was used as a leader. If it was a follower SAT you will need to re-link the SAT to the leader SAT as described in the section 'Link the other SAT(s) to the first (leader) SAT' (page 7). The firmware version will not be reset to the original production version.

## Volume

The volume settings can be found on the app's dashboard.

### **Master Volume**

The circular volume control allows you to change the master volume of the connected speakers.



### Speaker Volume

The volume controls below the master volume control control the individual volumes of each SAT. Each individual control can also be found under the general settings of the corresponding speaker. With the 'reset' icon below the individual volume controls, all controls can be reset to 50%.

### Touch Control

The volume control of the touch ring can be changed under the heading 'Touch Control'. There is a choice between master volume and local volume. When master volume is selected, you can control the master volume of the group with the touch ring of each SAT within the group. With local volume you only change the speaker volume of the SAT whose touch ring you use.

## Usage scenarios

### Remove SAT from the SAT group

*When another listener is connected to the SAT group, we recommend removing a follower from the group and switching to Bluetooth connect mode. This way you don't get in the way of the connection and therefore someone else's music. The follower can be recognized by the pink light in the status light. This can be solid blue-pink (connected), dim pink (standby) or flashing pink (seeking connection with the leader). For more information, see chapter 'Explanation of controls and light' (page 4).*

*Please note: the Kien app can only display one leader SAT, and therefore SAT group. Multiple streaming devices are required to operate and stream to a SAT group and individual SAT in Bluetooth connect mode.*

- Switch the follower to Bluetooth connect mode by briefly pressing the connect button once. While the SAT is initializing the Bluetooth connect mode, the status light will flash white briefly. You will then hear a signal and the light will start flashing blue.
- If you have not previously connected the SAT to your streaming device, press and hold the connect button until you hear the next signal. The SAT is now in Bluetooth pairing mode. The status light will begin to slowly pulse blue.
- Open your device's Bluetooth settings and select the SAT from the list of available devices. A connection signal follows and the status light now shows a constant blue light.
- If this SAT has previously been paired with your device, you do not need to activate pairing mode. While the light is flashing blue, the SAT will connect automatically or by selecting the SAT from the list of paired devices in your device's Bluetooth settings.

### Create a second SAT group

To create a second SAT group you need at least four SATs in total, or at least two per group. So take at least two follower SATs from the existing SAT group and switch one to the Bluetooth connect mode. In this way you allow the leader SAT of the existing group to exist and you do not get in the way of the possible connection and therefore the music of someone else. The follower can be recognized by the pink light in the status light. This can be solid blue-pink, dim pink or flashing pink. For more information, see chapter 'Explanation of controls and light' (page 4).



Please note: the Kien app can only display one leader SAT, and therefore SAT group. Multiple streaming devices are required to operate and stream to different SAT groups.

- Switch one of the followers to the Bluetooth connect mode by briefly pressing the connect button once. While the SAT is initializing the Bluetooth connect mode, the status light will flash white briefly. You will then hear a signal and the light will start flashing blue.
- If you have not previously connected the SAT to your streaming device, press and hold the connect button until you hear the next signal. The SAT is now in Bluetooth pairing mode. The status light will begin to slowly pulse blue.
- Open your device's Bluetooth settings and select the SAT from the list of available devices. A connection signal follows and the status light now shows a constant blue light.
- If this SAT has previously been paired with your device, you do not need to activate pairing mode. While the light is flashing blue, the SAT connects automatically or by selecting the SAT from the list of paired devices in the Bluetooth settings of your device.
- When your streaming device is connected to the SAT, pick up another SAT that is still in follower mode and press and hold the connect button until you hear a signal and the status light starts to pulse slowly.
- Open the Kien app and click on 'Add a follower' on the SAT dashboard. Click until you see the 'Accept follower' button and click on it. The follower will now be paired with the leader. Once the connection is made, you will hear a connection signal and the slowly pink pulsating status light will change to a constant blue-pink light.

## Firmware update

As soon as a firmware update becomes available, it will become visible in the Kien app. A yellow bar will appear on the tile of the connected SAT showing 'Update Available'. Click on the tile and then click on the 'Firmware' section. A list of instructions will appear on the screen that are important to complete before pressing the 'Update' button.

- Place the SAT on the charger to charge
- prevent the SAT from dropping out during the update.
- Keep your streaming device close to the SAT.
- Keep the app open and leave the SAT alone during the update.

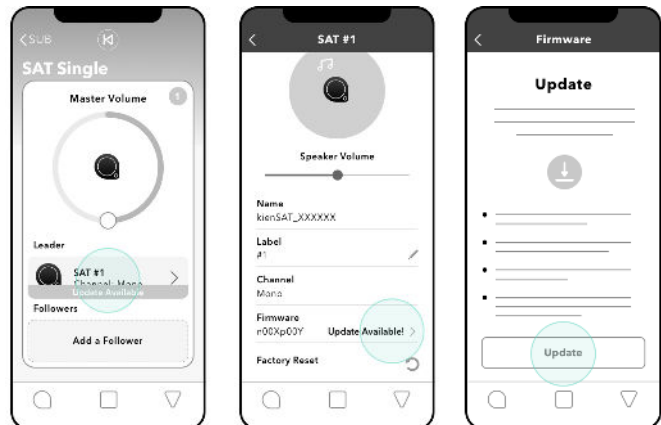

The status light will turn off for the first half of the update. The SAT will then restart, after which the status light will begin to pulse orange during the second half of the update. Once the update is complete, the SAT will restart again and the app will indicate that the update was successful. Click 'Done' to return to the dashboard.

When the screen indicates that the update has failed, the SAT will restart automatically. Wait until the status light flashes blue or is solid blue again. Then click "Retry update."

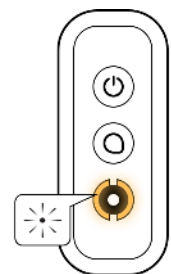



If the firmware update continues to fail, please contact us.

## Specifications

### Model

kien SAT

### Mains supply

Oplader: 100-240 VAC, ~50/60 Hz. 24V, 1.5A max

### Housing type

Bass reflex

### Speakers

- Two 2-inch mid-woofers:  
The mid-woofers provide realistic reproduction of voices in the mid frequencies and a deep and full bass sound.
- One 1-inch tweeter:  
The tweeter ensures a clear and accurate response in the high frequencies.

### Amplifier

Two digital class D amplifiers, both with a power of 40 W.

### Frequency range

70 - 20.000 Hz

### Wireless connections

- Bluetooth version 4.0
- Kleernet, for communication with other smart speakers

### Average power consumption

10 W

### Battery playing time

12 hours, at medium volume

### Battery charging time

2 hours to fully charge

### Product dimensions (H x W x D)



200 x 200 x 70 mm

### Weight

1,5 kg



## Important safety information

1. Read these instructions
2. Save these instructions.
3. Heed all warnings.
4. Follow all instructions.
5. Do not use this device near water.
6. Clean only with a dry, soft cloth. Household cleaners or solvents can damage the finish of Kien products.
7. Do not block the ventilation holes. Install according to manufacturer's directions.
8. Do not install Kien products near heat sources such as radiators, heating registers, stoves or other appliances (including amplifiers) that produce heat.
9. Ensure that the power cord is not likely to be walked on, pinched, and is tangle-free, especially at plugs, convenience receptacles, and where they exit from the apparatus.
10. Only use attachments/accessories specified by the manufacturer.
11. Unplug the appliance during lightning storms or if the appliance will not be used for a long time.
12. Refer all maintenance to qualified kien maintenance personnel. Servicing is required when the apparatus has been damaged in any way, such as a power-supply cord or plug is damaged, liquid has been spilled or objects have fallen into the apparatus, the apparatus has been exposed to rain or moisture, does not operate normally, or has been dropped. .
13. Warning: To prevent fire and electric shock, this device must not be used exposed to rain or moisture. The device must not be exposed to dripping or splashing liquids. Make sure that no objects filled with liquids, such as vases, are placed on the apparatus. 
14. Warning: The battery of the SAT should not be exposed to excessive heat such as sunshine, fire or the like.
15. Connect only to the correct mains voltage.
16. The plug in the socket must be easily accessible to disconnect the power supply.
17. This device should be installed and used with more than 3cm distance between the antenna and your body.
18. This device may only be used indoors when it operates in the frequency spectrum 5170-5250 MHz.
19. Proper disposal of this product. This marking indicates that this product is not with other household waste may be thrown away within the EU. For possible damage to the environment or human health through uncontrolled waste disposal occur, recycle it responsibly to promote sustainable reuse of materials. 
20. Use the return and collection systems to return your used device.
21. Do not place open flames, such as lighted candles, on or near the appliance.
22. Maximum operating temperature is 45°C
23. The SAT's battery provides best performance when used at a normal room temperature of 20°C (68°F) ± 5°C (9°F).
24. The SAT battery is not user serviceable. Please contact Kien Support for any battery related issues.